

88 5077 691

# Pantry

## IMPORTANT NOTE

Carefully remove all the parts from the carton and put them individually on a soft cloth to prevent scratches or other damages occurring to the parts.

We have taken great care in the design of this product and request that you carefully and strictly follow our assembly instructions to ensure a completed product as it was designed.

*Home  
Styles*

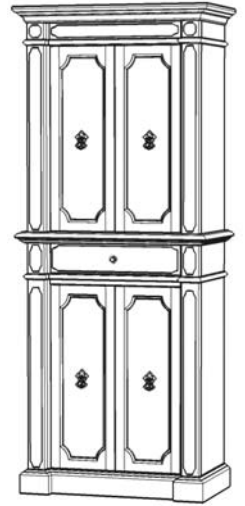

## Part List

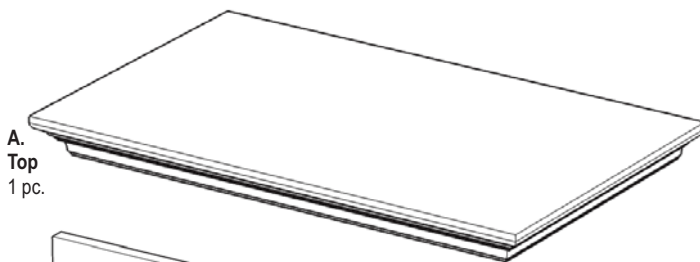

A.  
Top  
1 pc.

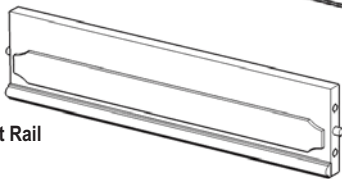

B.  
Front Rail  
1 pc.

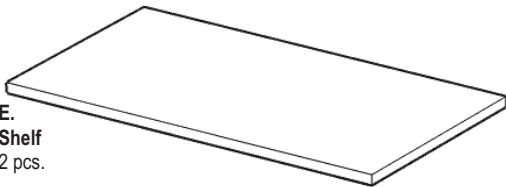

E.  
Shelf  
2 pcs.

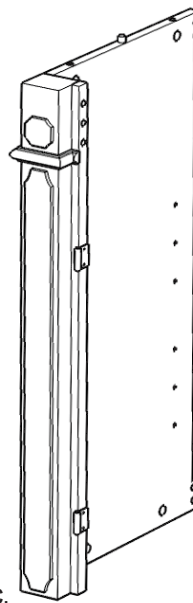

C.  
Side Panel  
1 pc.

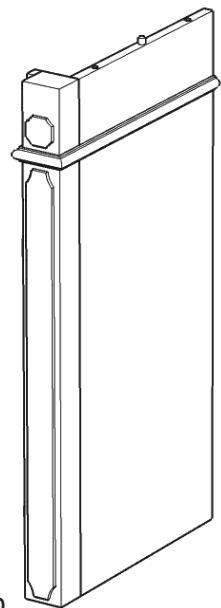

D.  
Side Panel  
1 pc.

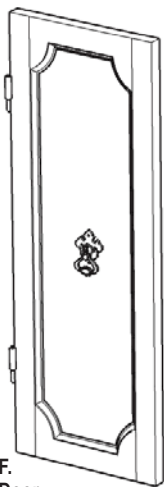

F.  
Door  
1 pc.



G.  
Door  
1 pc.

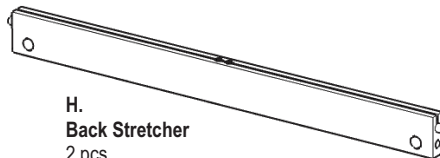

H.  
Back Stretcher  
2 pcs.



I.  
Back Piece  
1 pc.

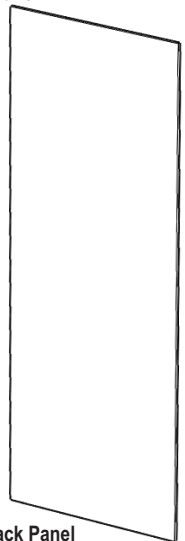

J.  
Back Panel  
2 pcs.

For assembly see instructions in carton 88 5077 692

Home Styles Consumer Assistance Line 888-680-7460 and 877-831-0319  
[servicedesk@homestyles-furniture.com](mailto:servicedesk@homestyles-furniture.com)

88 5077 692  
**Pantry**

**IMPORTANT NOTE**

Carefully remove all the parts from the carton and put them individually on a soft cloth to prevent scratches or other damages occurring to the parts.

We have taken great care in the design of this product and request that you carefully and strictly follow our assembly instructions to ensure a completed product as it was designed.

*Home  
Styles*

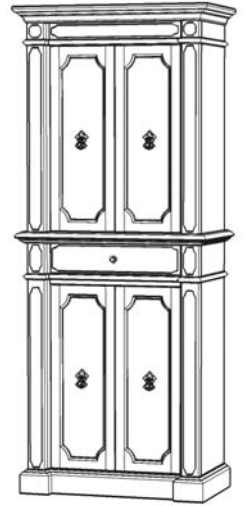

**Part List**

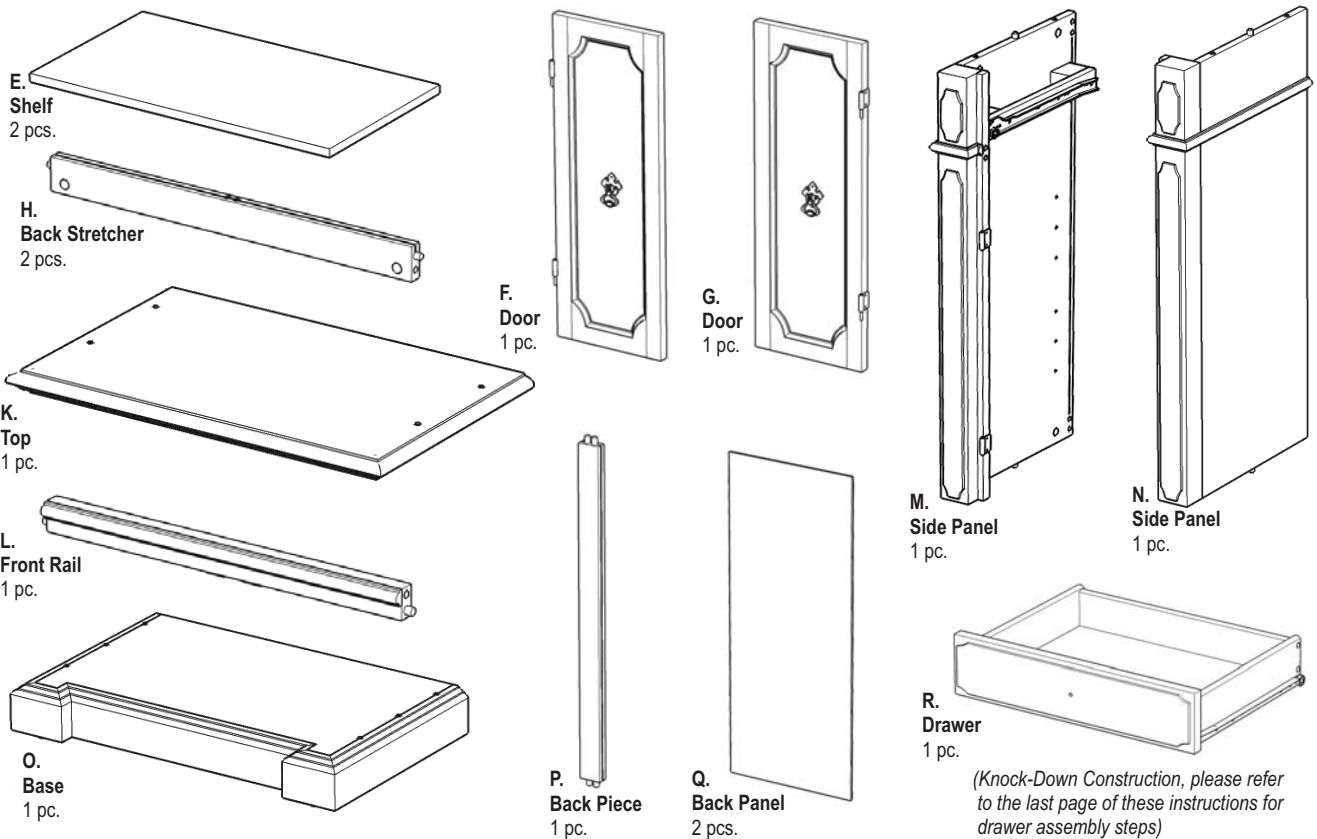

**Hardware List**



**Also need the following from carton 88 5077 691**

**Tools required for assembly :** Phillips screwdriver, Drill, 3/8" Drill Bit, Level

**Home Styles Consumer Assistance Line 888-680-7460 and 877-831-0319**  
**[servicedesk@homestyles-furniture.com](mailto:servicedesk@homestyles-furniture.com)**

## Assembly Instructions 2/8

### IMPORTANT

- \* Do not tighten up all the screws until each part is properly assembled.
- \* You should keep Hex Wrench in a safe place as you may need to tighten up the Cam Locks in the future.
- \* Use a soft cloth between these parts and the floor.
- \* After assembly, item must be level to work properly. Use the included adjustable levelers to level.

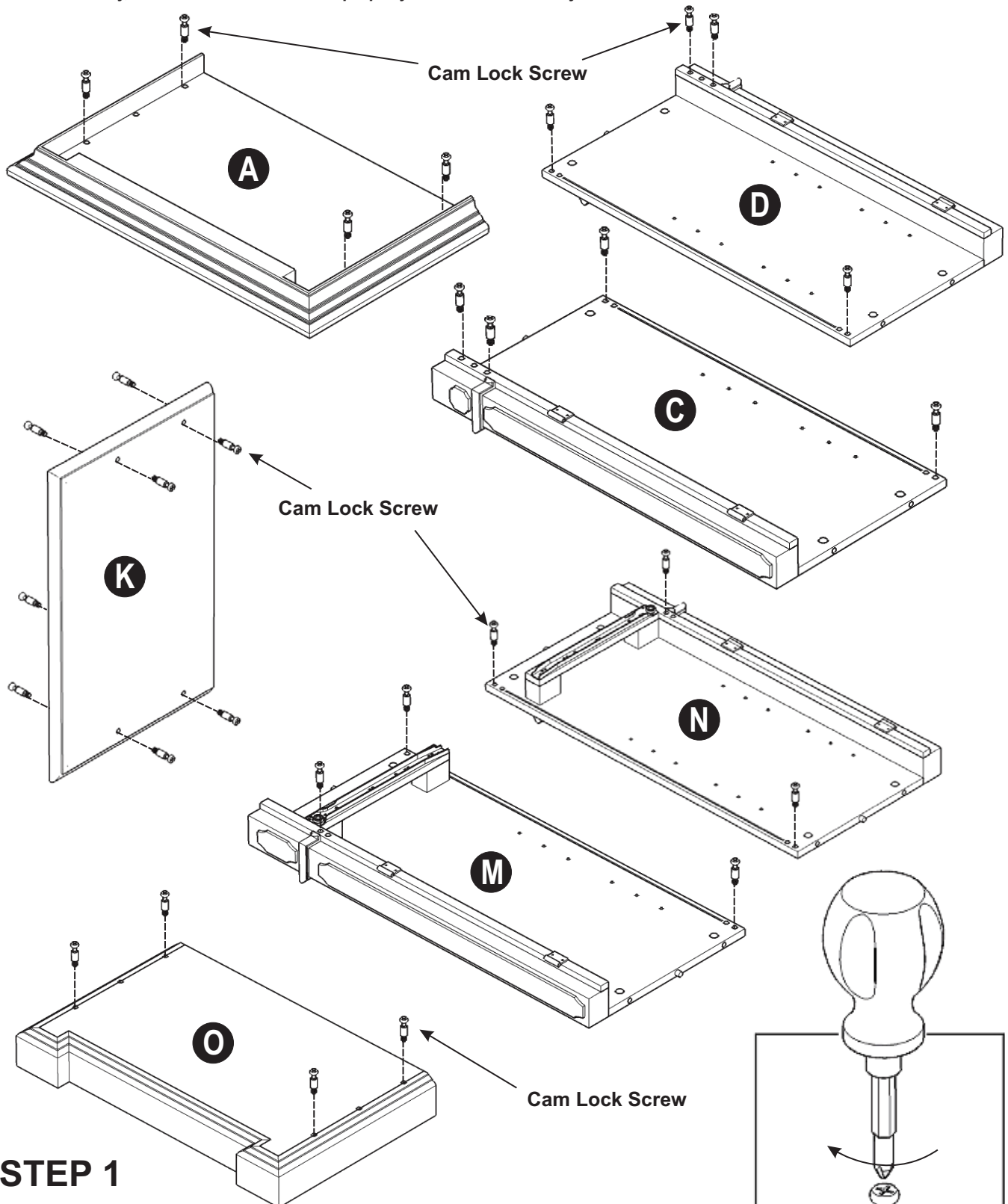

### STEP 1

Put Cam Lock Screws into the pre-drilled holes of Top (A), (K) Side Panels (C), (D), (M), (N) and Base (O) and tighten. (see Figure 1)

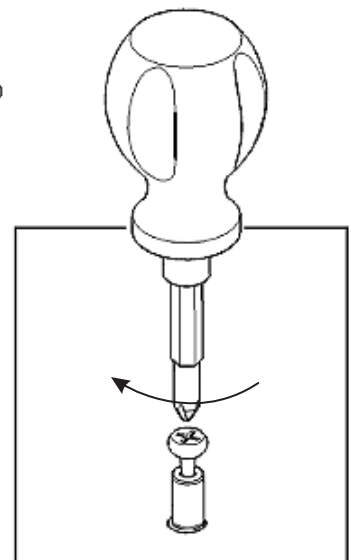

Figure 1

## STEP 2

Attach Back Stretcher (H) to Side Panel (M) with Cam Lock.  
(see Figure 2)

Attach Back Piece (P) to Back Stretcher (H).

Slide Back Panels (Q) into position.

Attach Back Stretcher (H) and Front Rail (L) to unit with Cam Locks.

Attach Side Panel (N) to unit with Cam Locks.

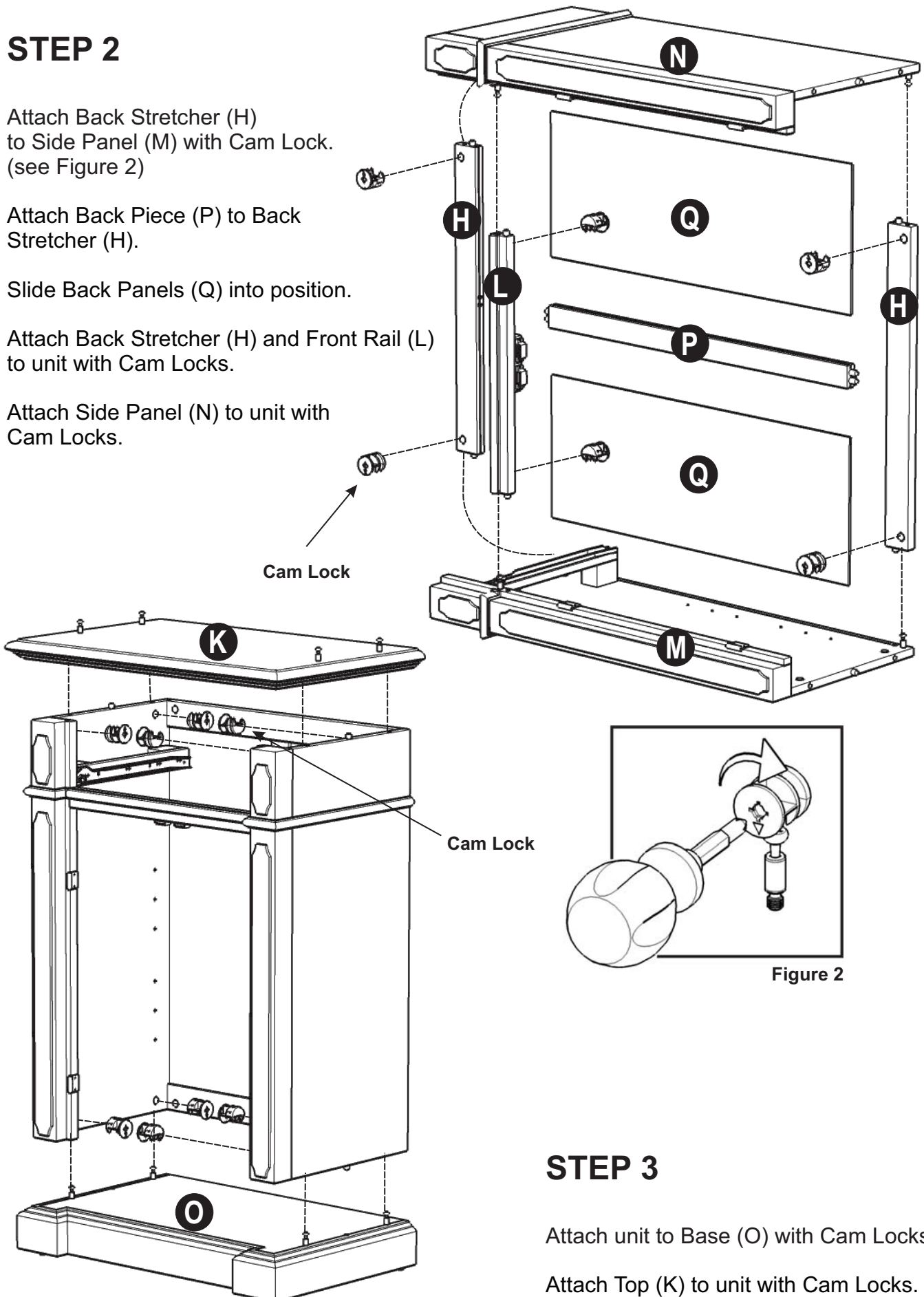

## STEP 3

Attach unit to Base (O) with Cam Locks.

Attach Top (K) to unit with Cam Locks.

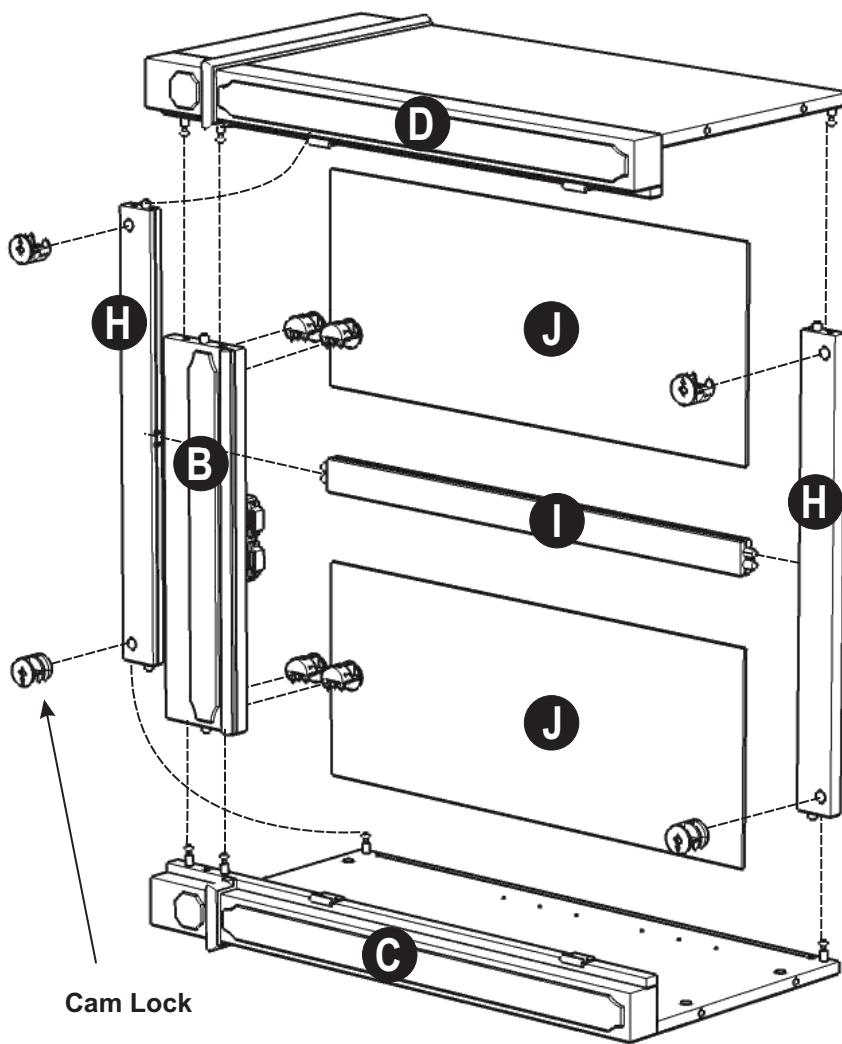

## STEP 4

Attach Back Stretcher (H) to Side Panel (C) with Cam Lock.

Attach Back Piece (I) to Back Stretcher (H).

Slide Back Panels (J) into position.

Attach Back Stretcher (H) and Front Rail (B) to unit with Cam Locks.

Attach Side Panel (D) to unit with Cam Locks.

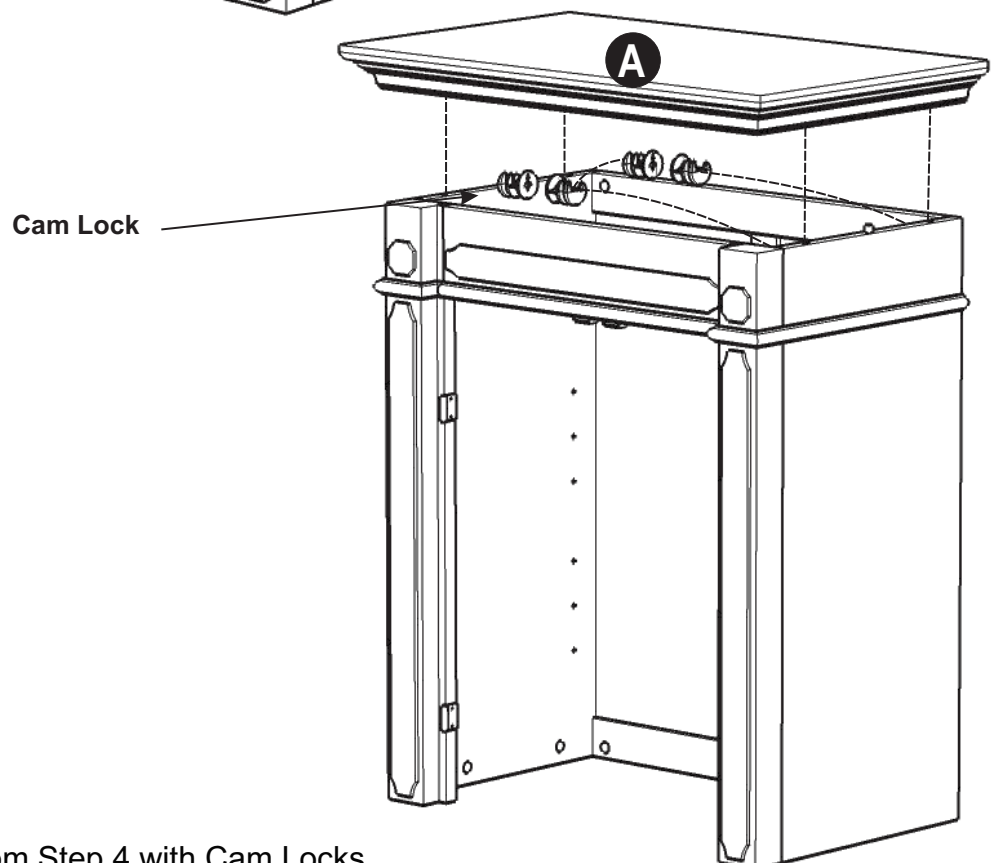

## STEP 5

Attach Top (A) to unit from Step 4 with Cam Locks.

## STEP 6

Attach unit from Step 5 to unit from Step 3 with Cam Locks.

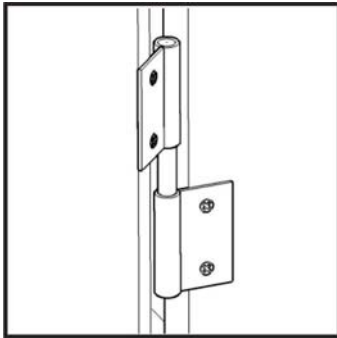
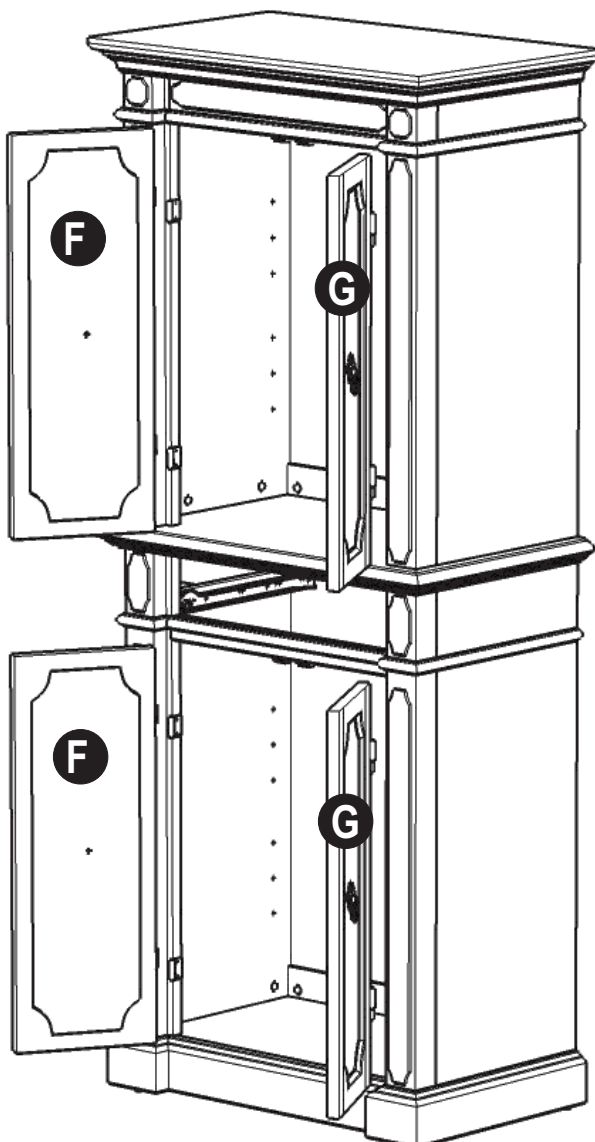
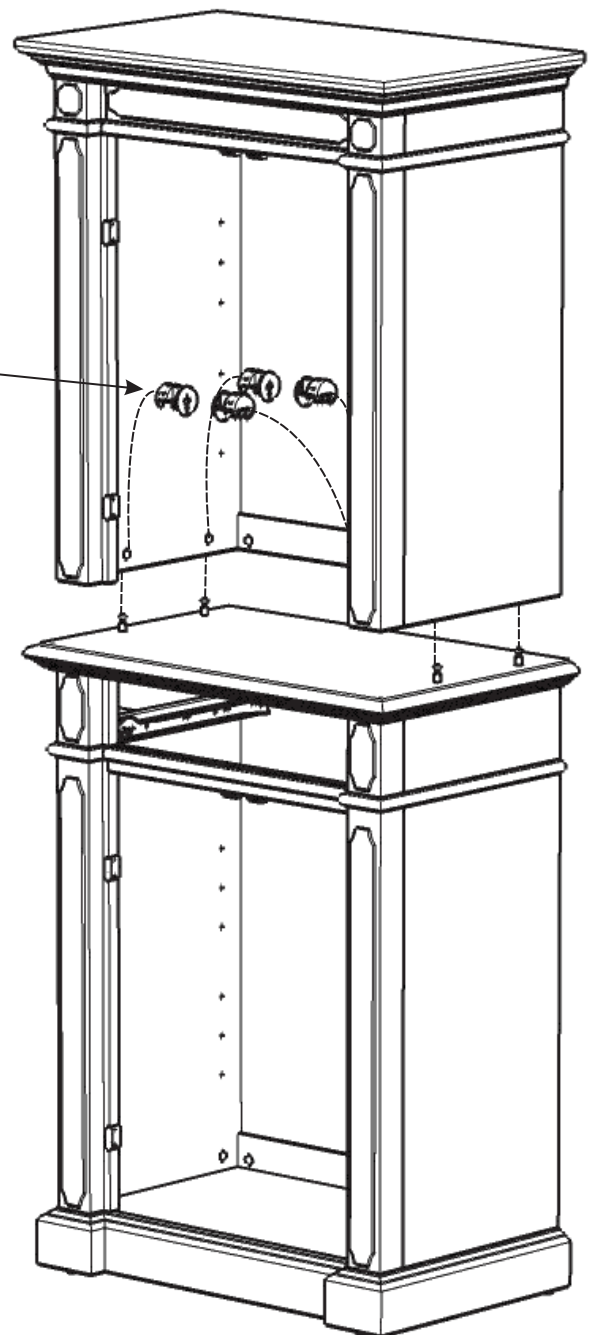

Figure 3

Cam Lock



## STEP 7

Attach Doors (F) and (G) to unit by sliding the door lift hinges into the side panel lift hinges. (see Figure 3)



## STEP 8

Insert the Adjustable Pins into the side panels at the desired level.

Place Shelves (E) into position.

Slide Drawer (R) into position.

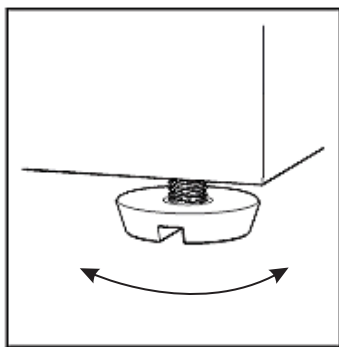
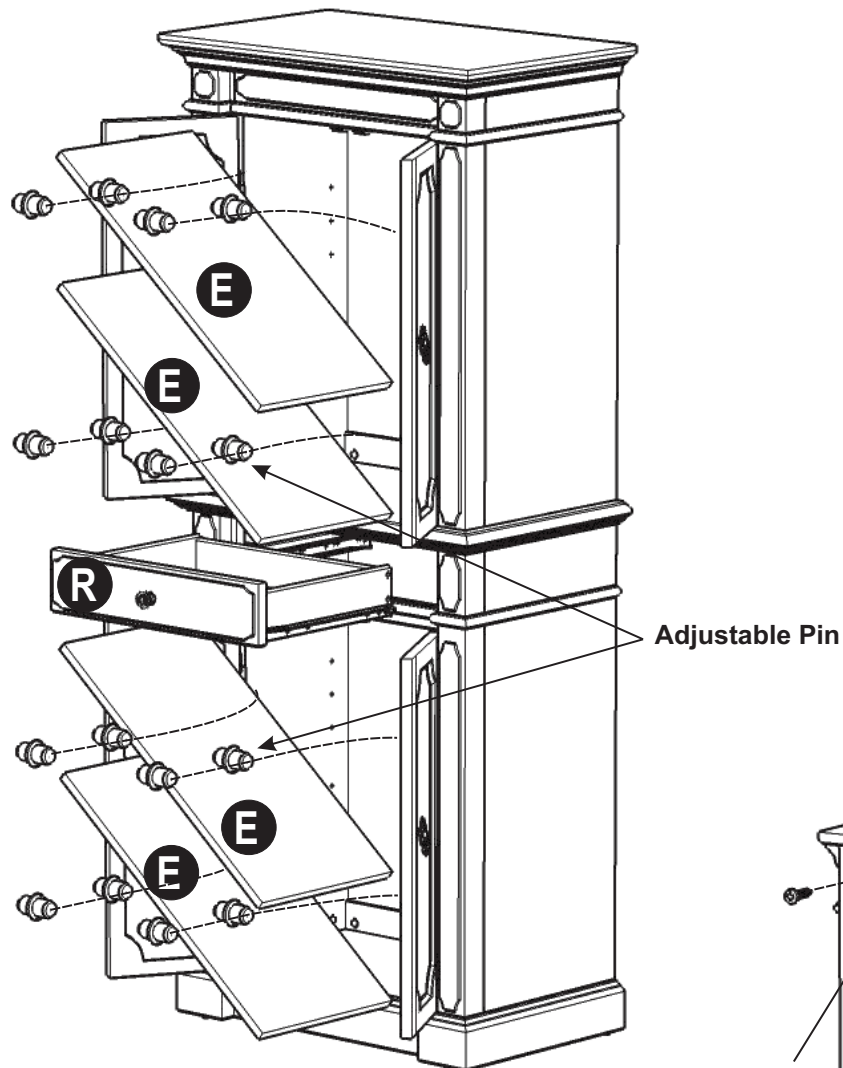

Figure 4

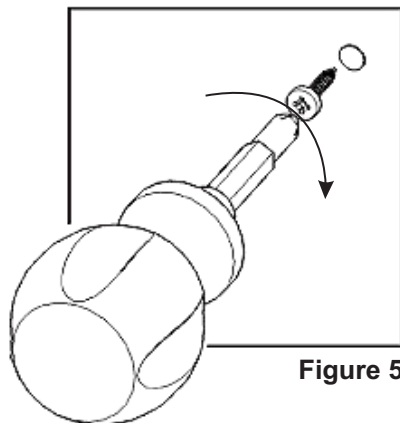

Figure 5

## STEP 9

To level the unit, adjust the adjustable levelers on the bottom of unit. (see Figure 4)

Insert Wood Screws (short) from the back of the unit and tighten. (see Figure 5)

**Note: Unit must be level before tightening these screws.**

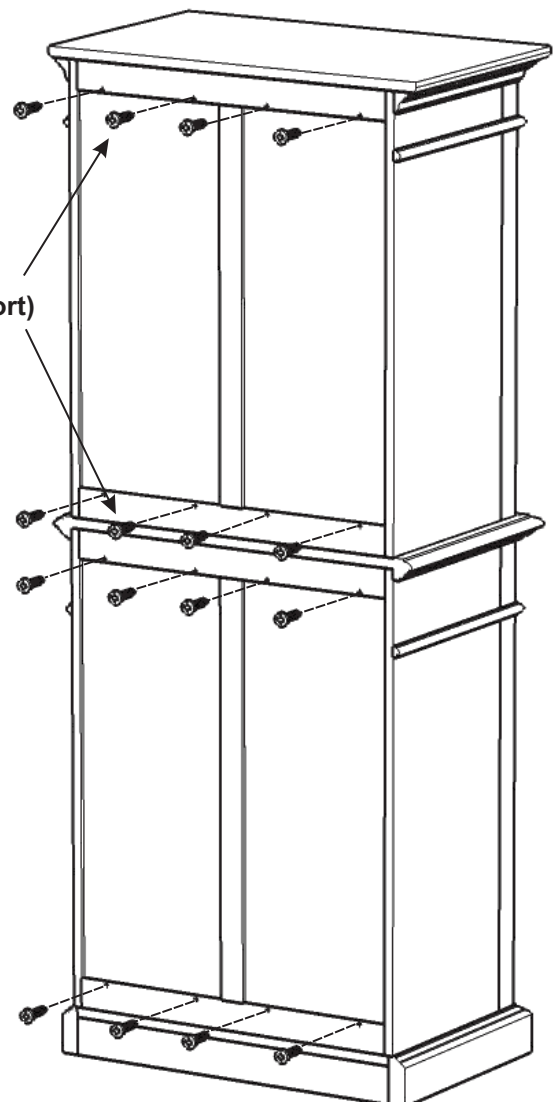

## Assembly Instructions 7/8

### Attention!

To help reduce the risk of the unit tipping over, the Tipover Restraint must be installed following these instructions exactly!

Place unit at desired location.

Drill a 3/8" hole in wall at the appropriate location.

Insert Anchor into the wall hole and attach Bracket with Wall Screw.

Attach Bracket at pre-drilled hole at top of unit with Wood Screw.

Use Tipover Restraint to secure Bracket on unit to Bracket on wall.  
(see Figure X)

Put tie end of Tipover Restraint into loop end of Tipover Restraint and pull until tight.

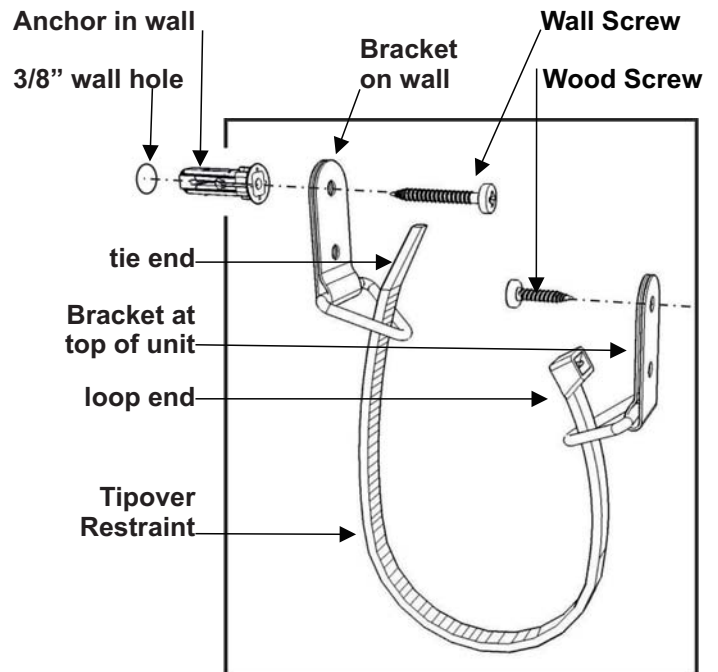

**Figure X**

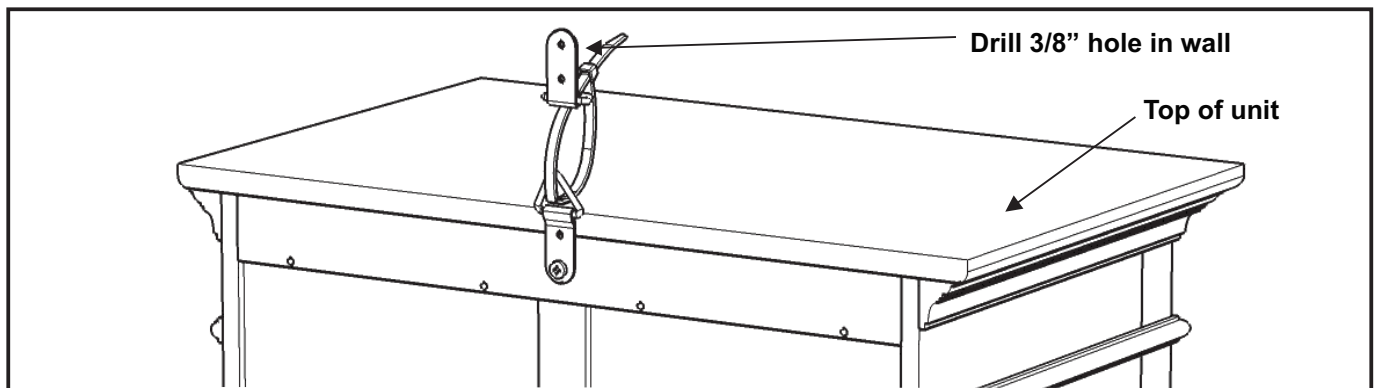

## Hardware List

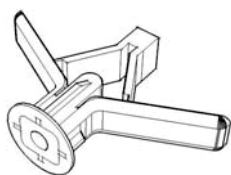

**Anchor**  
1 pc.(+1 extra)

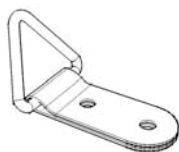

**Bracket**  
2 pcs.(+1 extra)

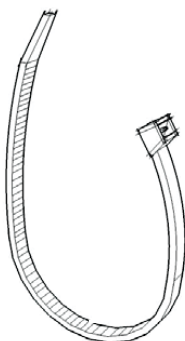

**Tipover Restraint**  
1 pc.(+1 extra)



**M3.5x40  
Wall Screw**  
1 pc.(+1 extra)

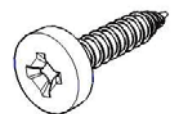

**M3.5x13  
Wood Screw**  
1 pc.(+1 extra)



## Drawer R

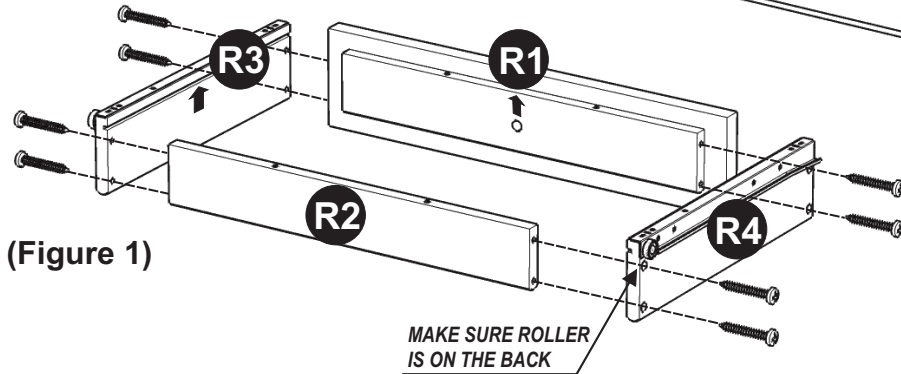

(Figure 1)

### STEP 1

Attach R1 to R3 and R4, using Wood Screws (long), tighten halfway.

Attach R2 to R3 and R4 using Wood Screws (long), tighten halfway. (see Figure 1)

### STEP 2

Slide R5 into the grooves in R3 and R4. Be sure to push R5 all the way forward to it meets R1. (see Figure 2)

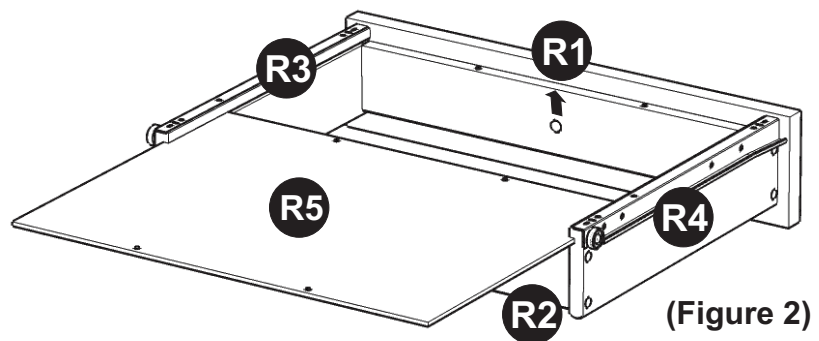

(Figure 2)

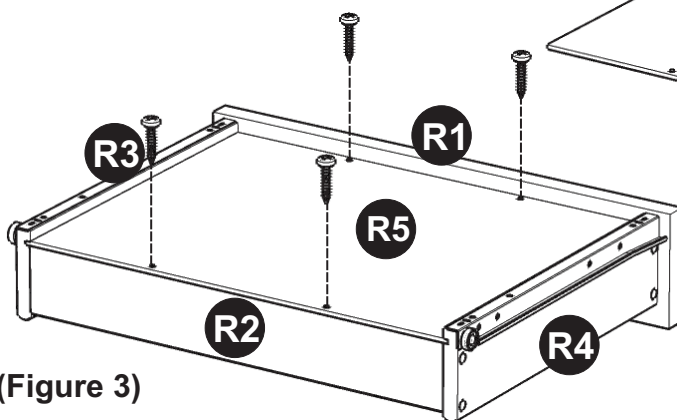

(Figure 3)

### STEP 3

Insert Wood Screws (short) into the pre-drilled holes in R5, tighten screws. (see Figure 3)

### STEP 4

Attach Knob with machine screw. (see Figure 4)

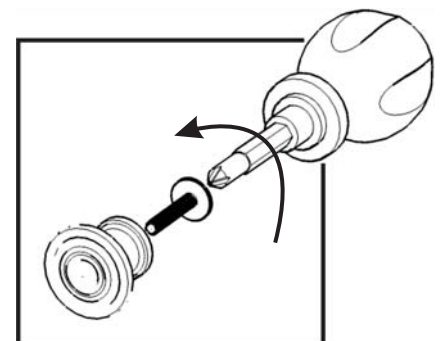

(Figure 4)

**Tighten all screws used in drawer assembly.**

## Part List

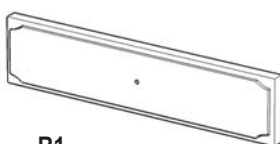

R1.  
Drawer Front  
1 pc.



R2.  
Drawer Back  
1 pc.

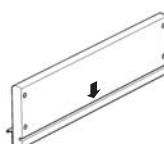

R3.  
Drawer Side  
1 pc.



R4.  
Drawer Side  
1 pc.



R5.  
Drawer Bottom  
1 pc.